

FRALDÁRIOS

ESCALA 1/25

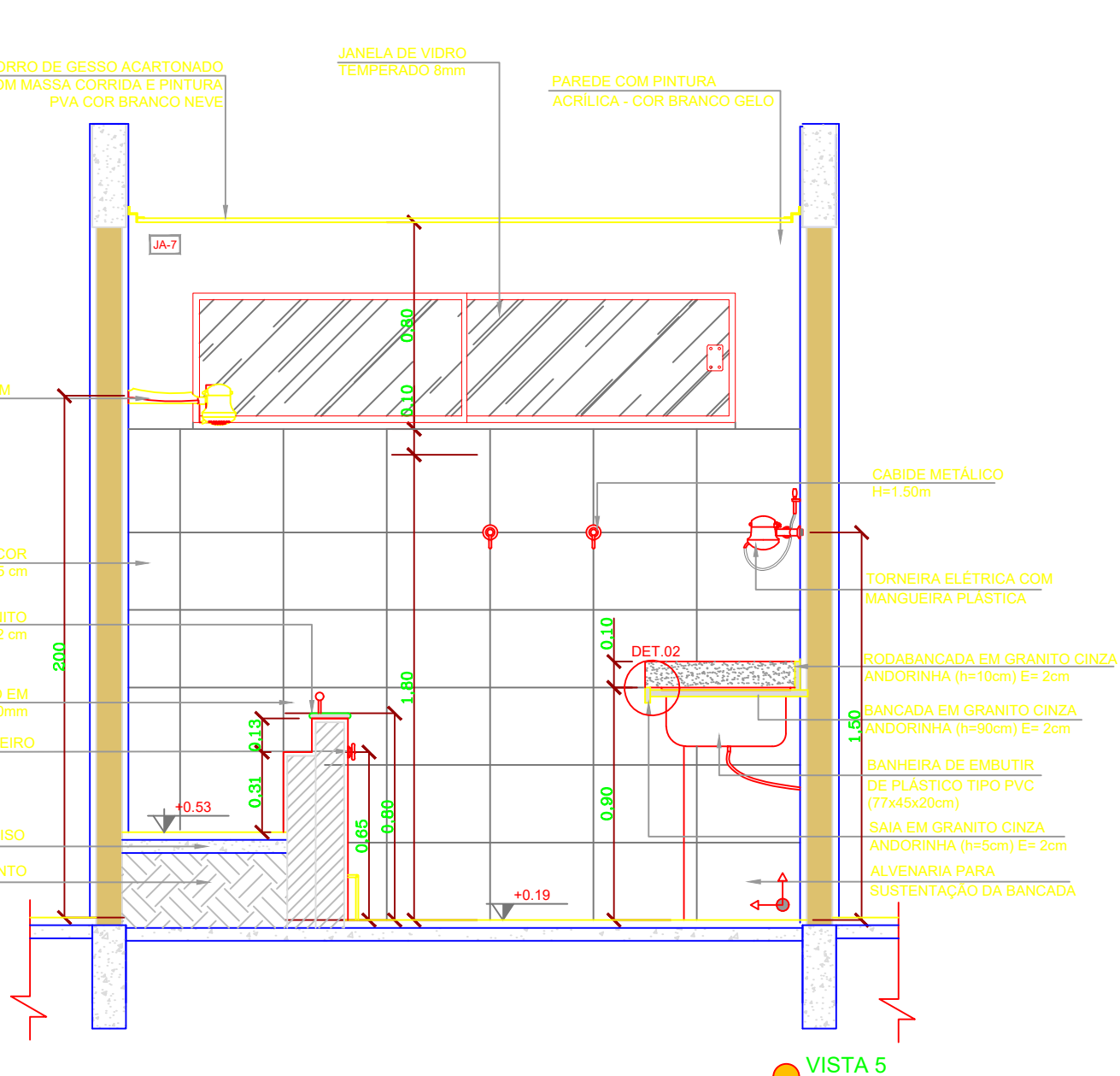
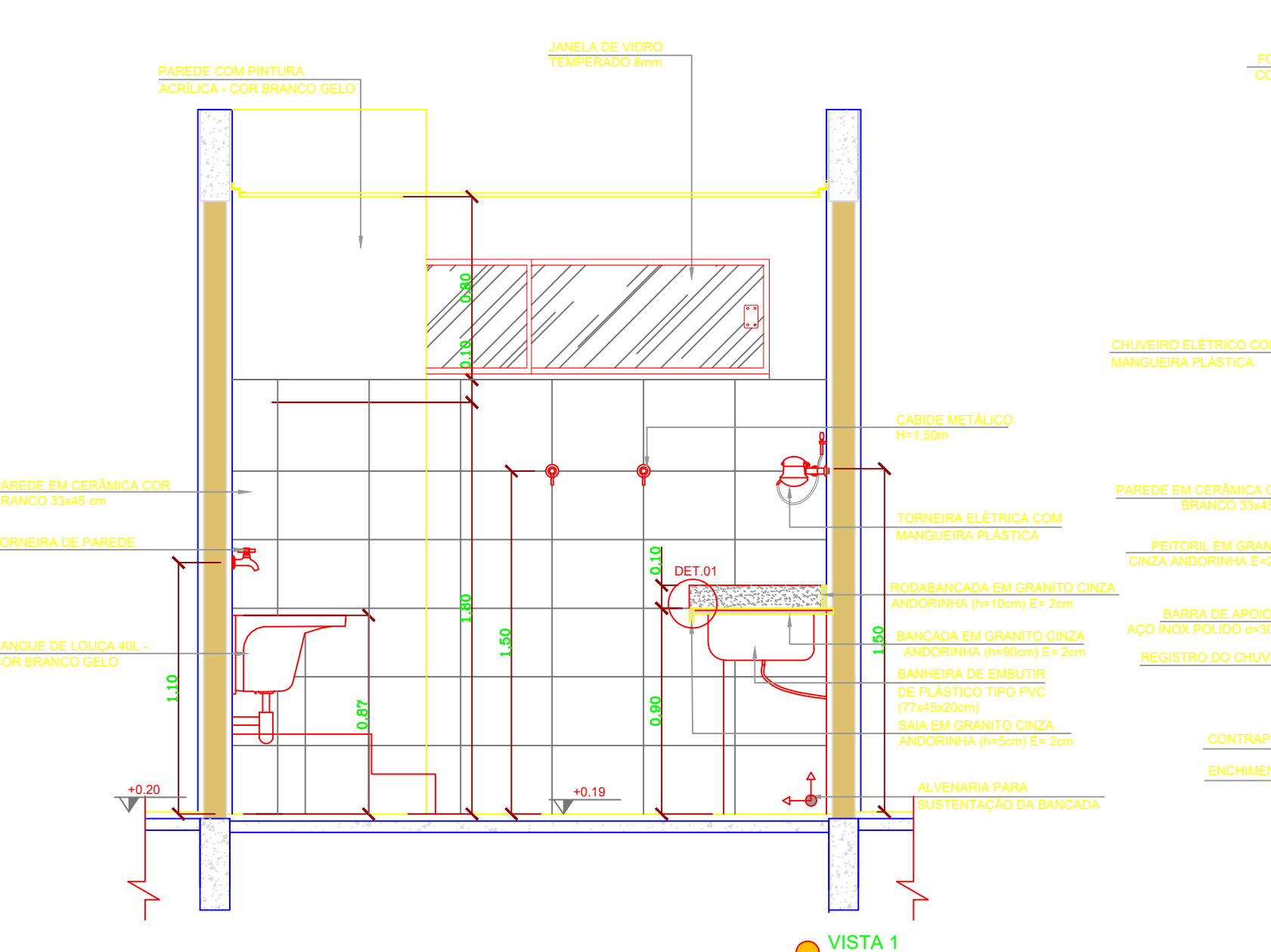
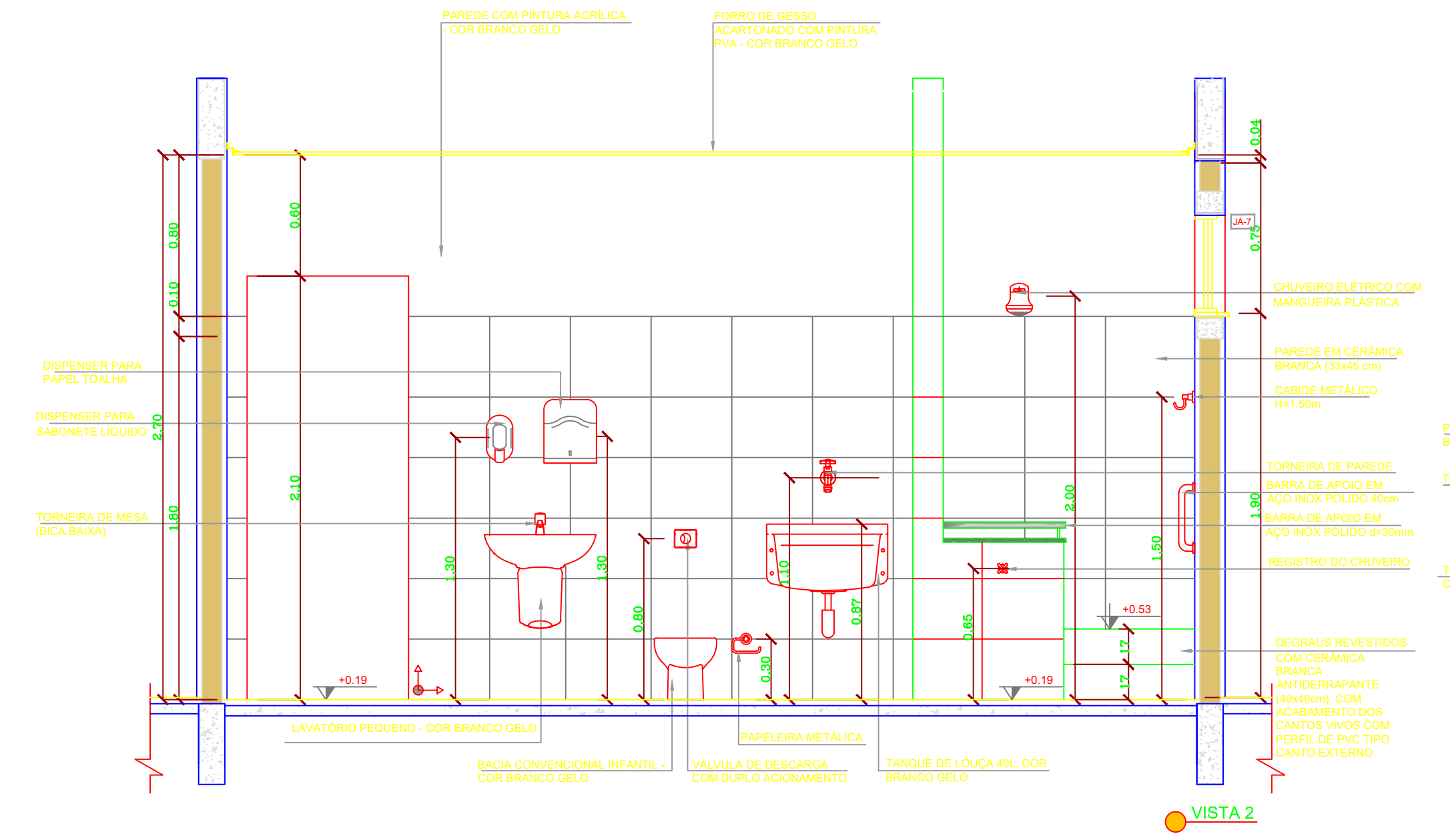
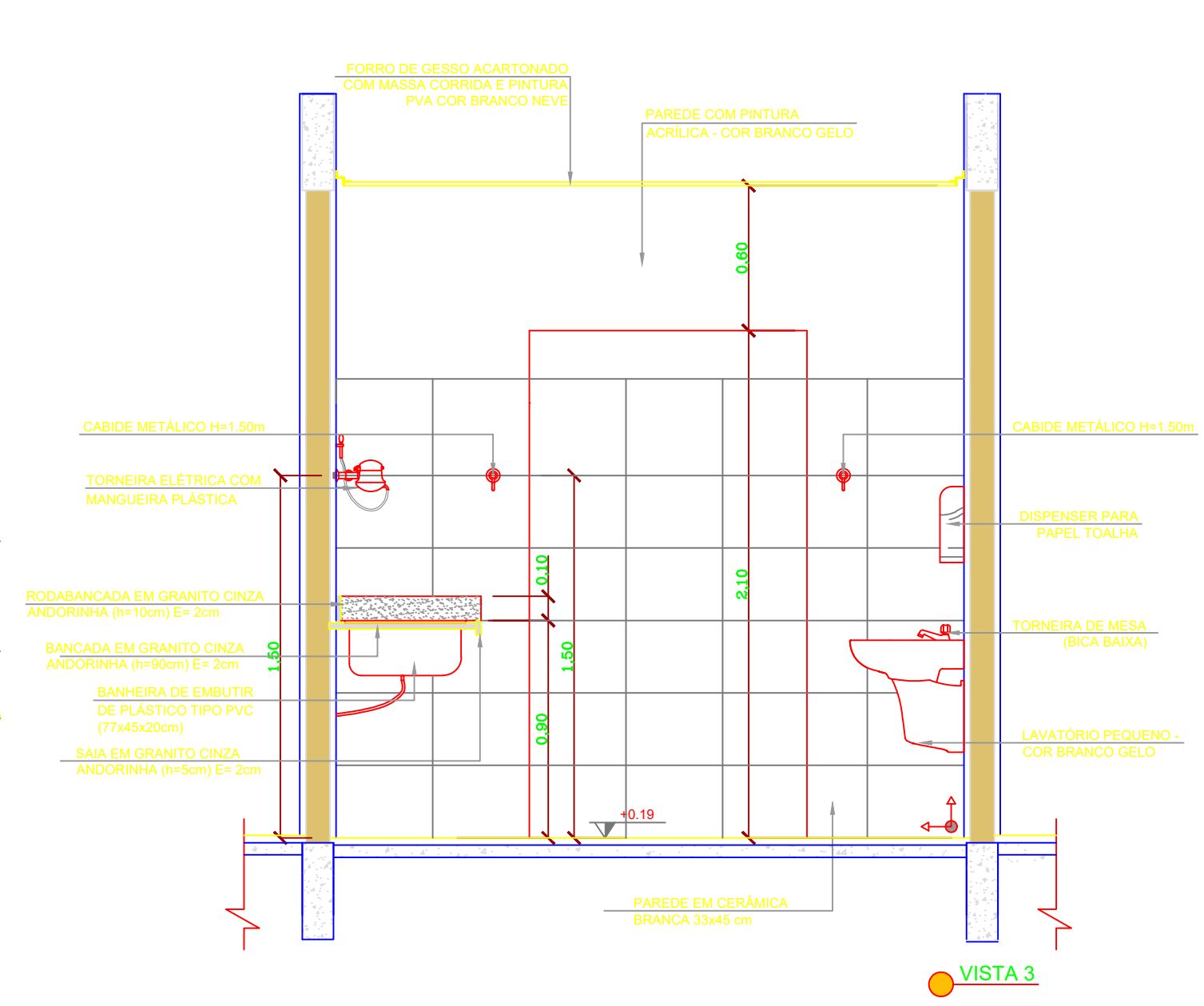
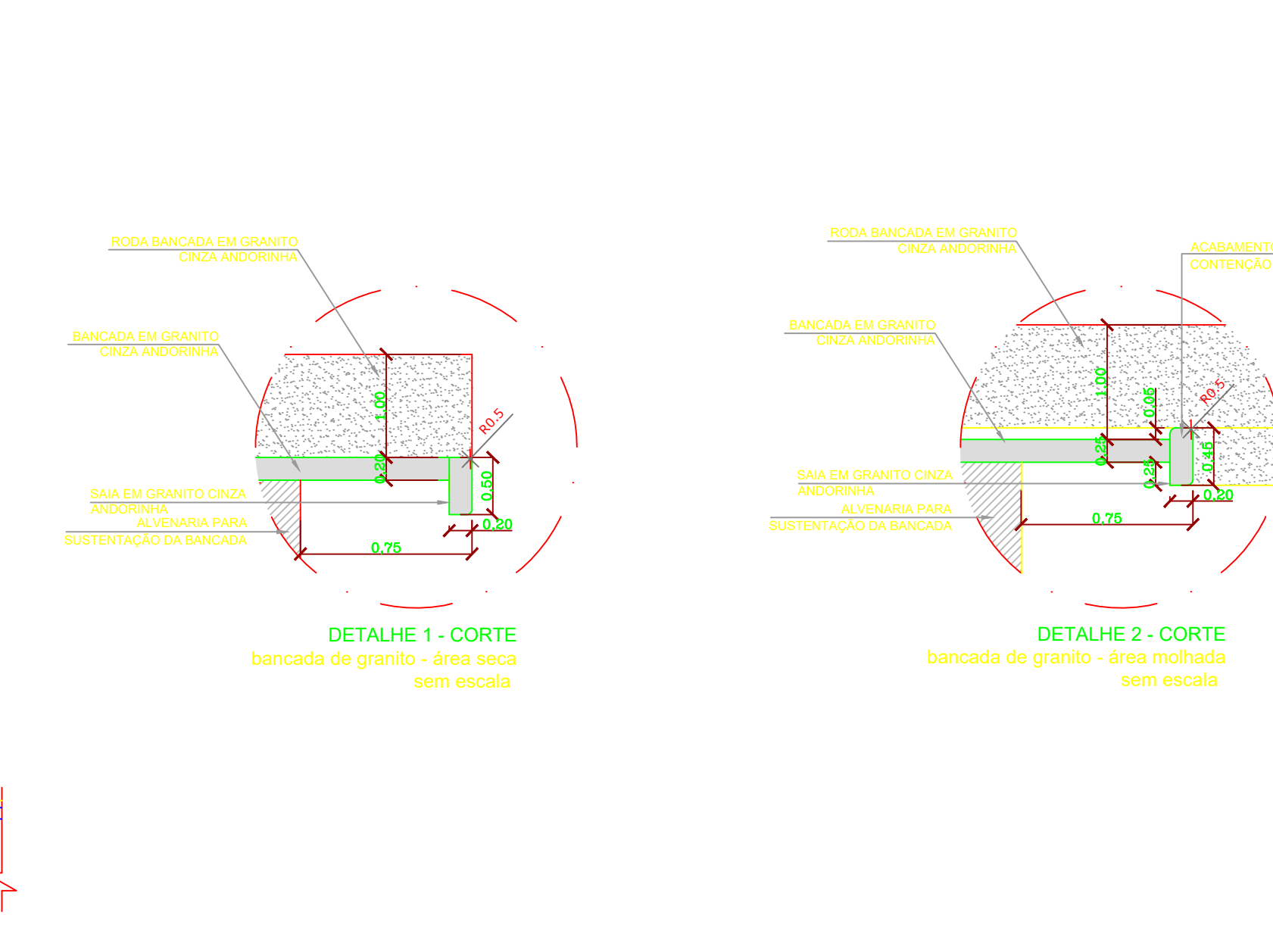
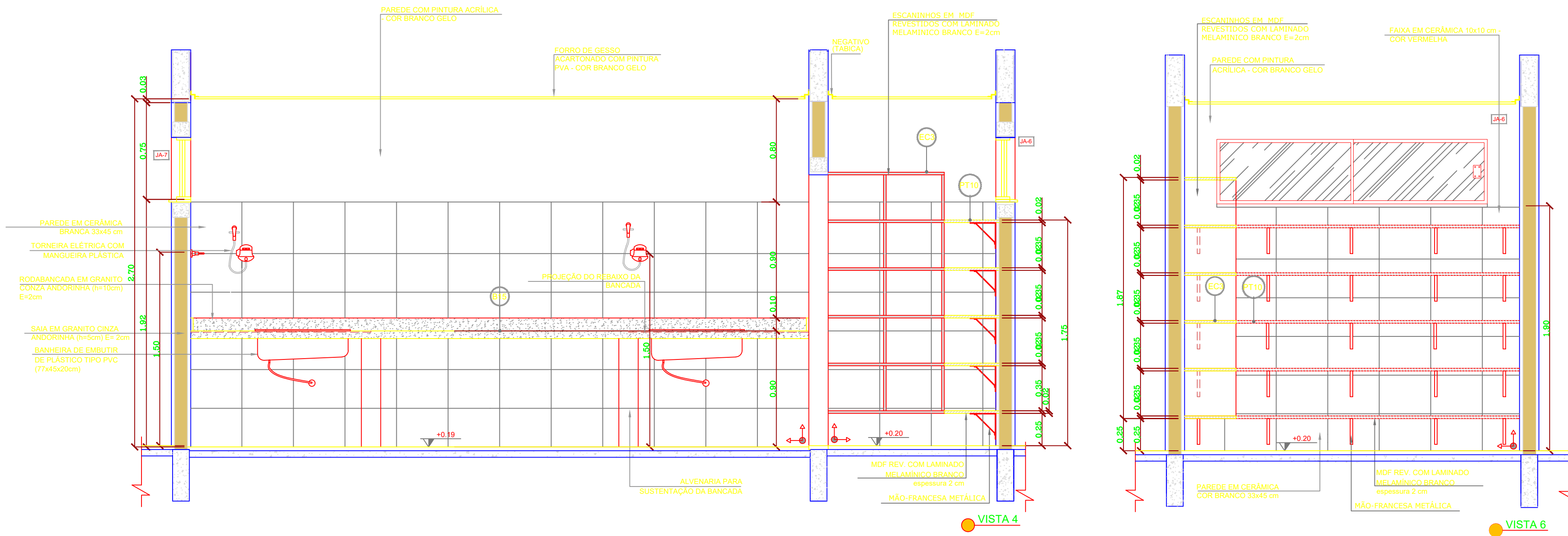
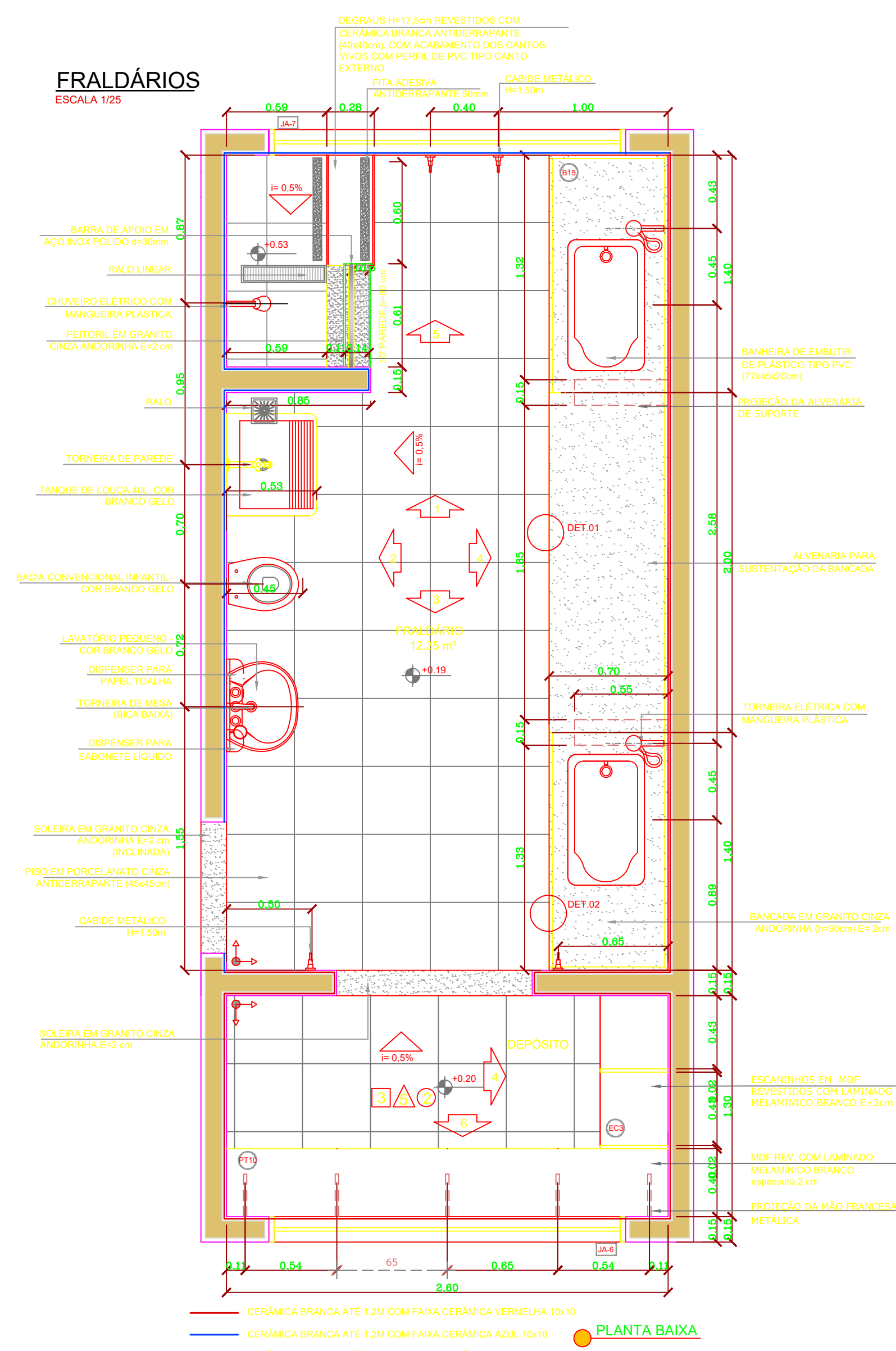

SANITÁRIO PCD FEM. E MASC.

ESCALA 1/25

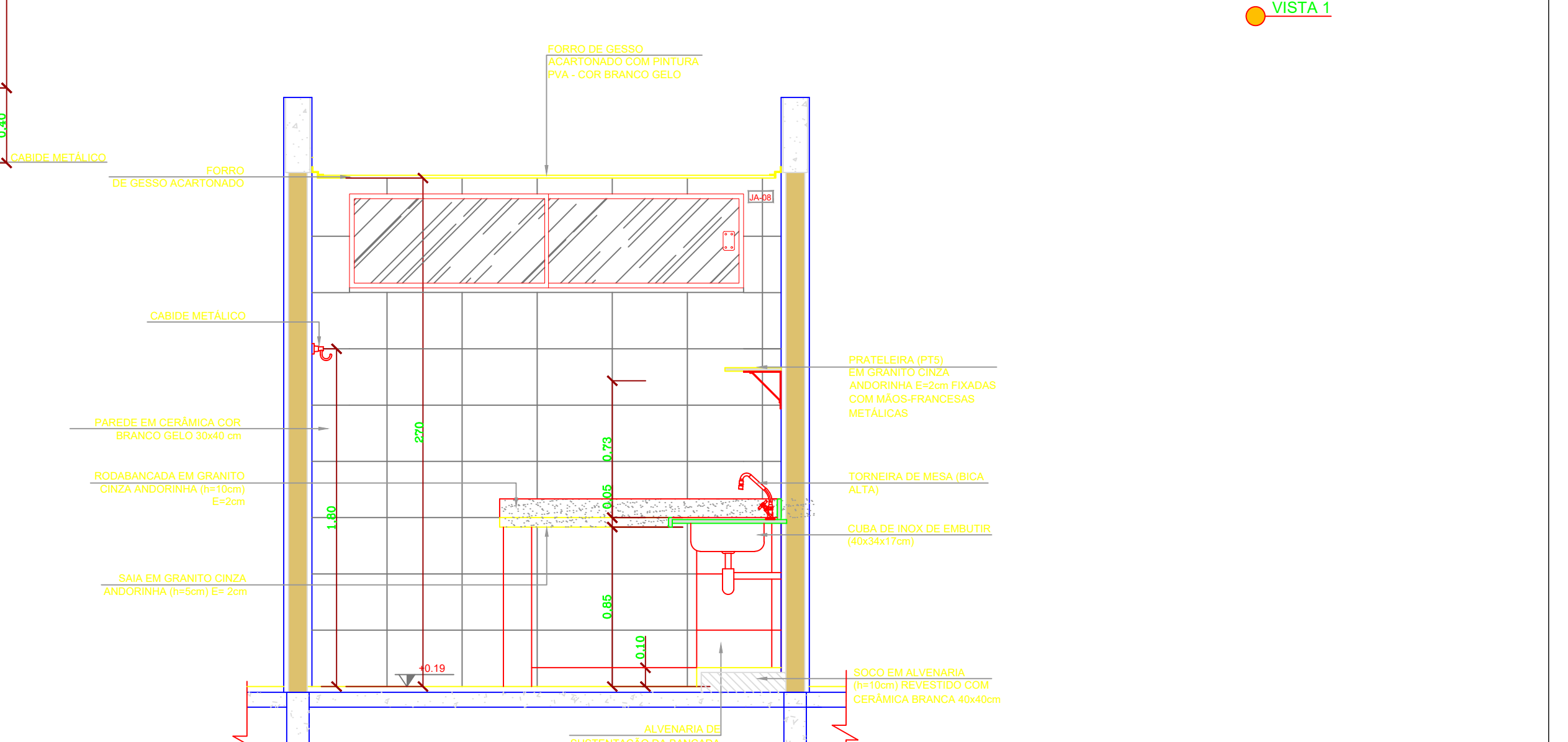
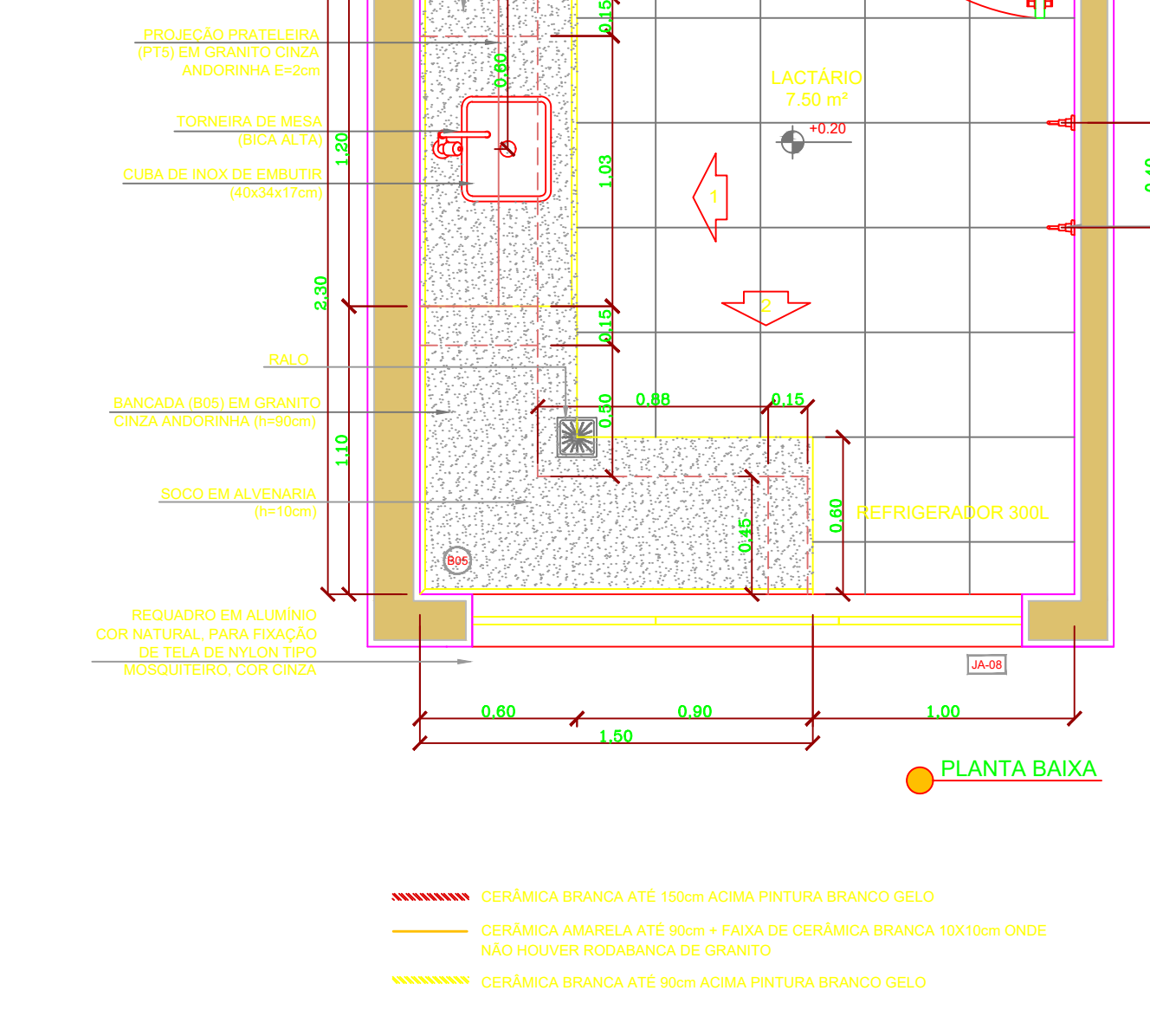
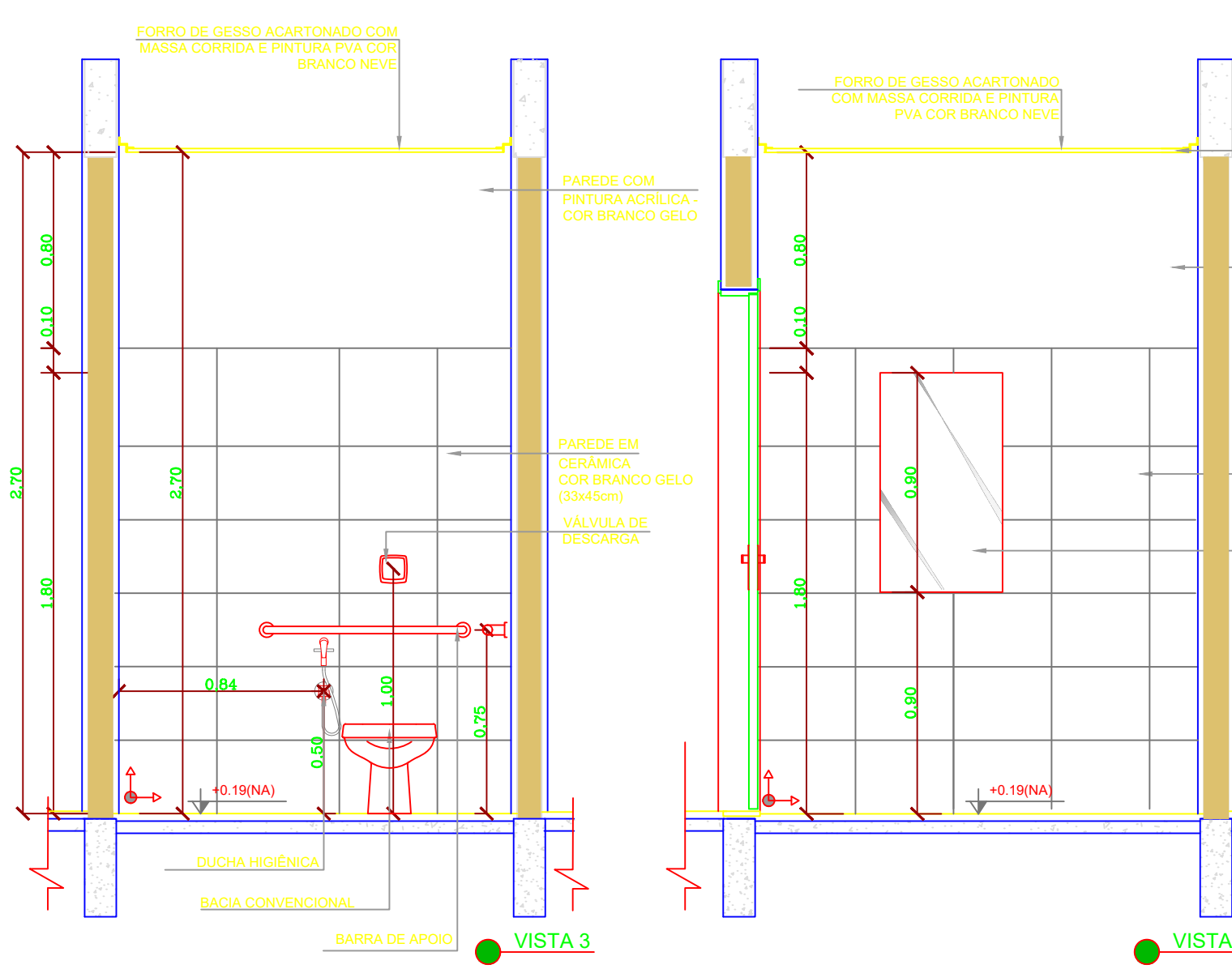
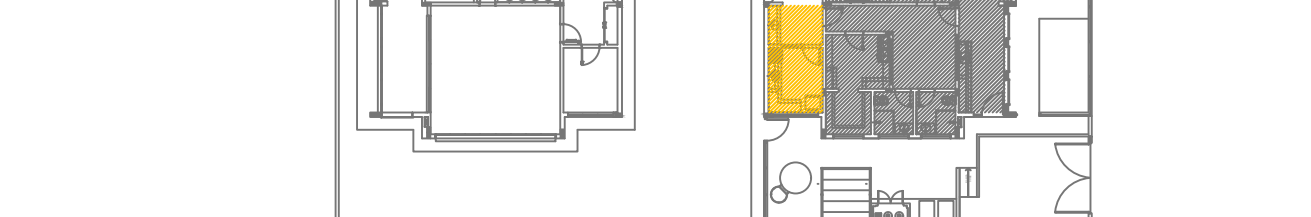
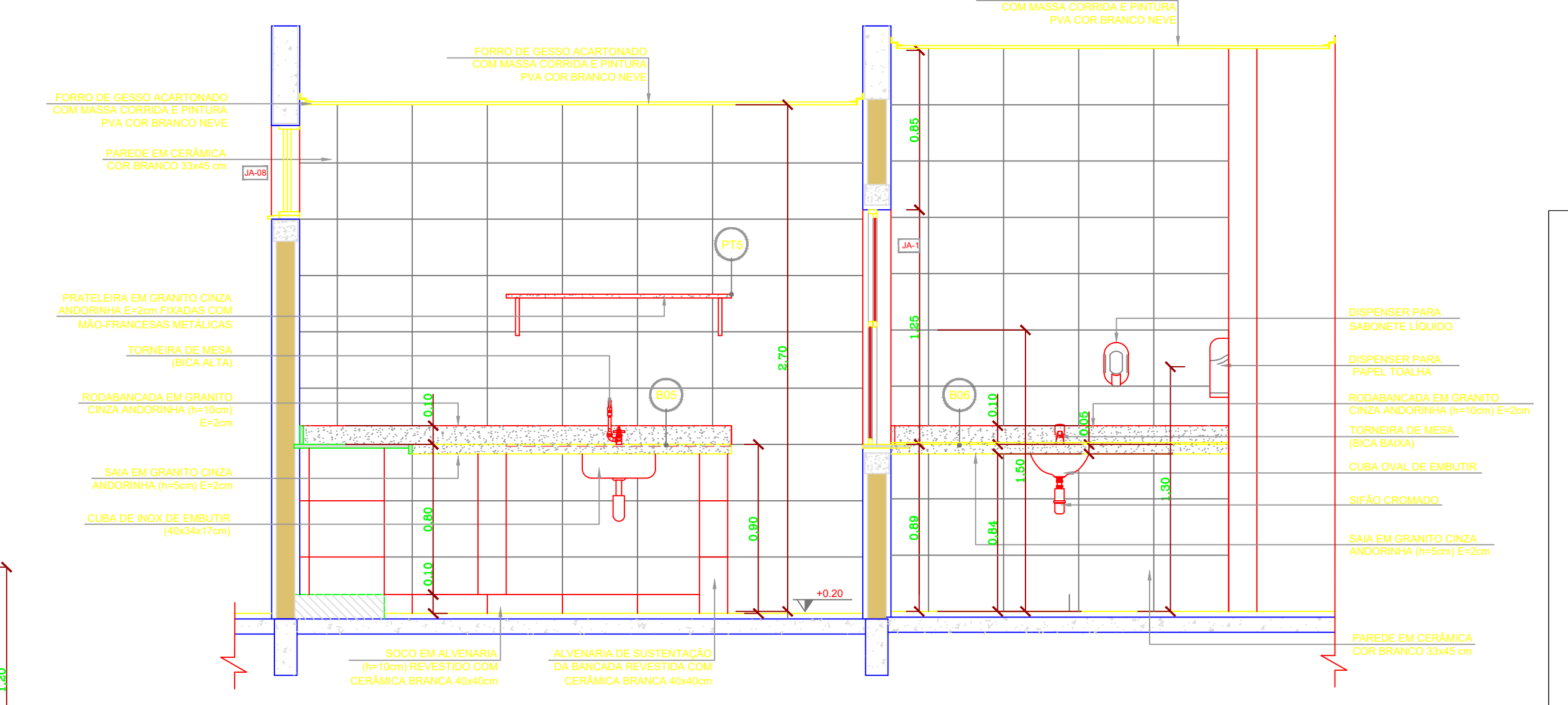
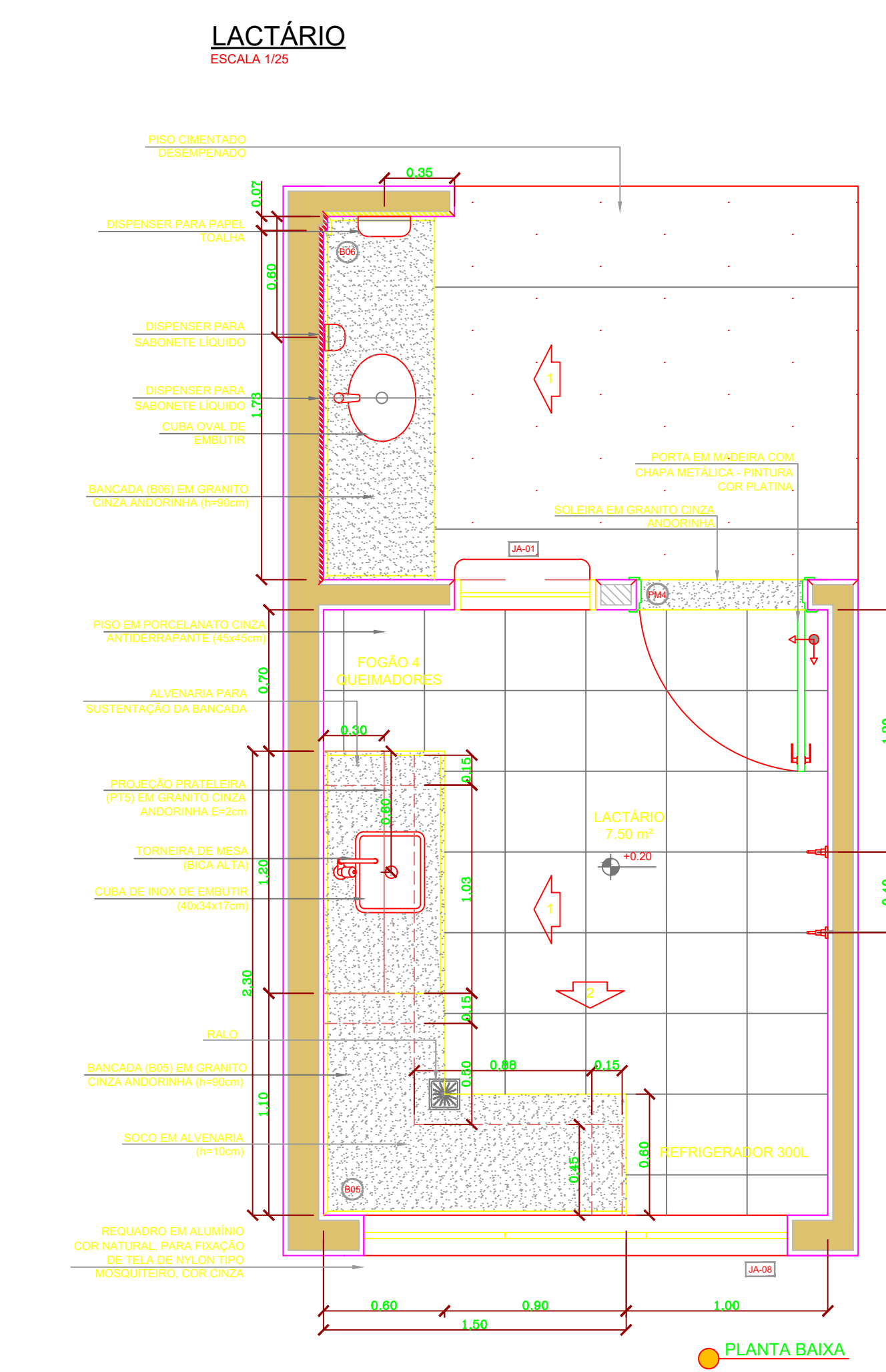
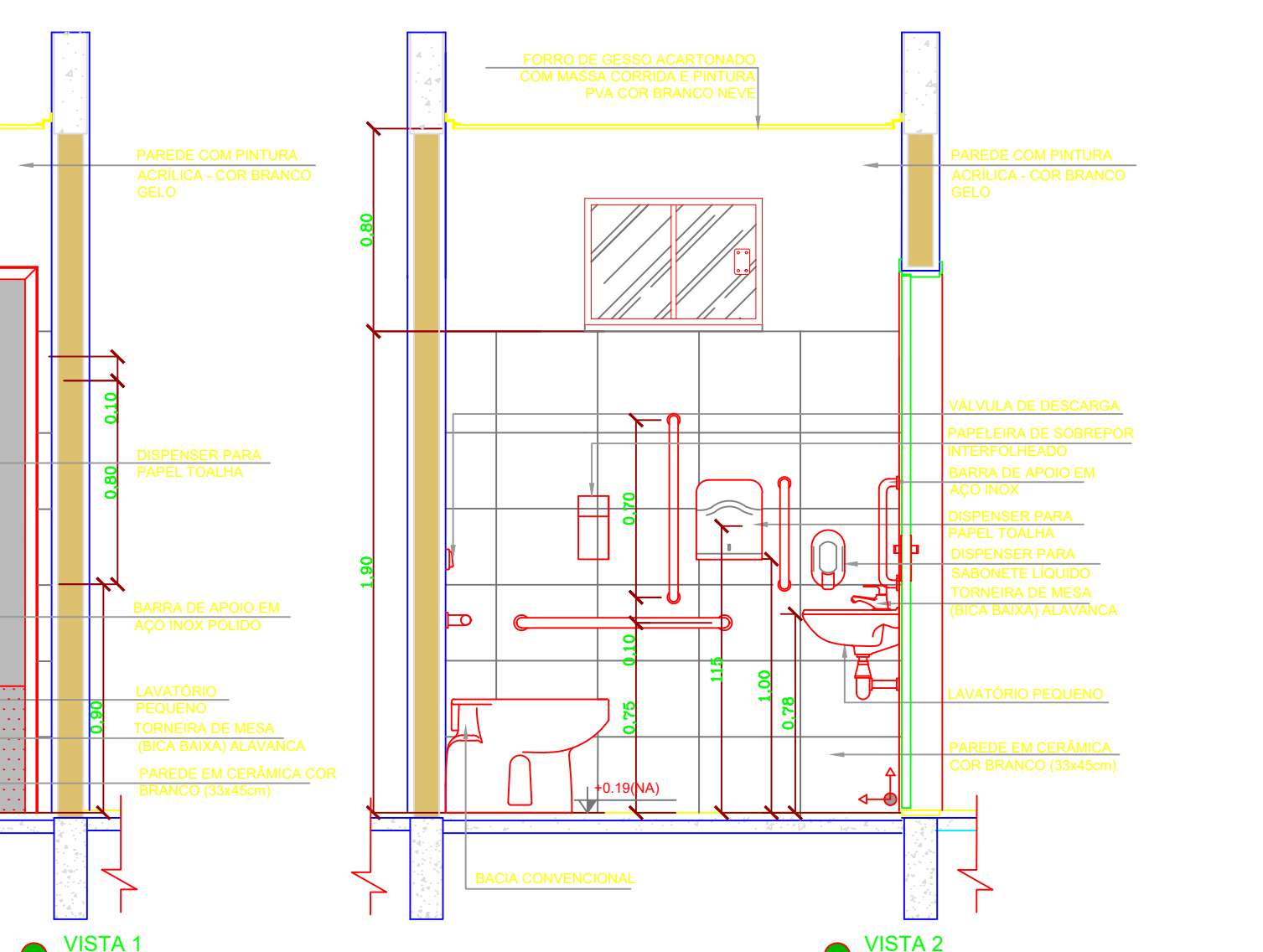
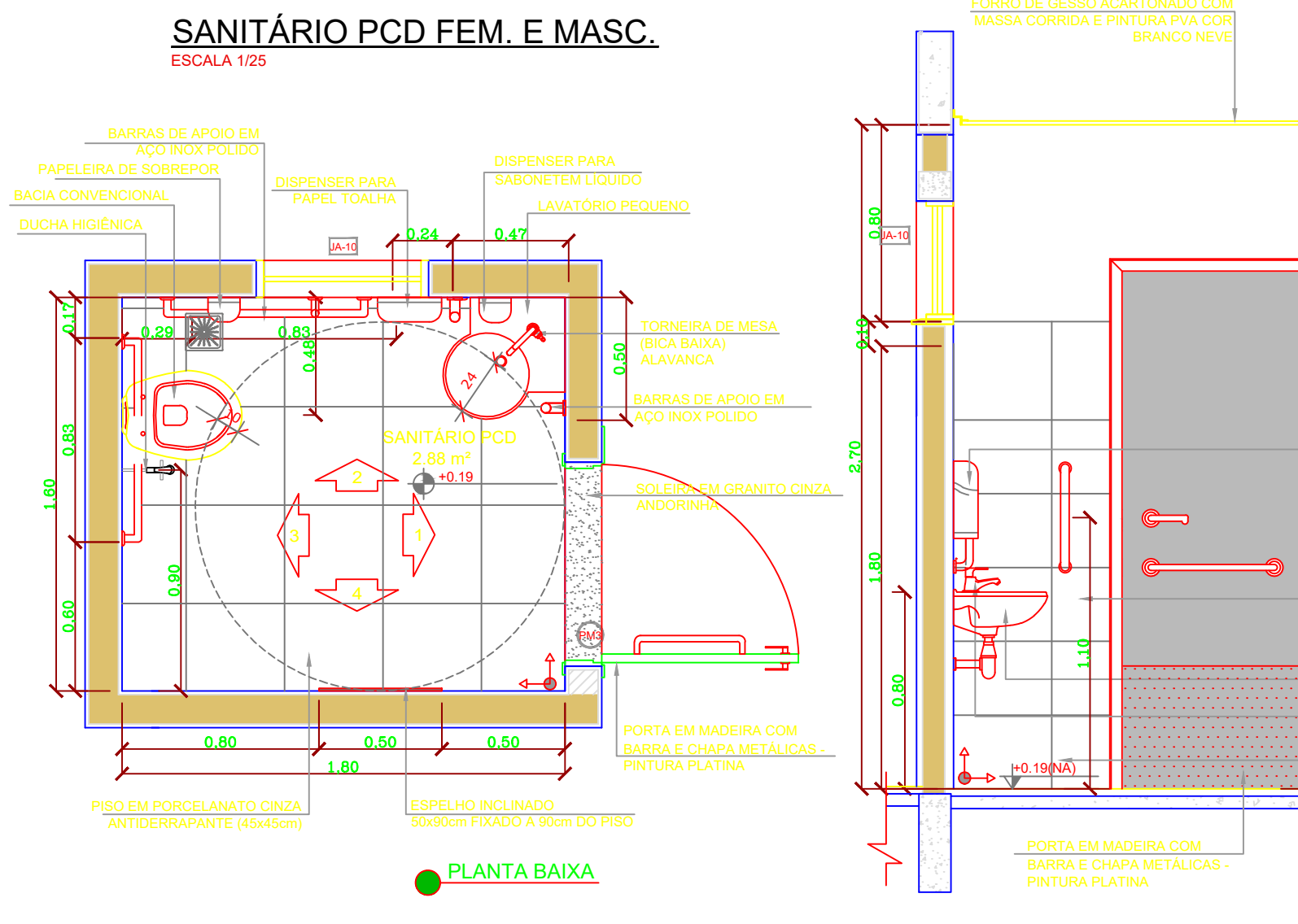

Projeto		ARQUITETÔNICO INSTITUCIONAL		Data		NOV./2019	
Especificações		PROJETO ARQUITETÔNICO PARA CONSTRUÇÃO DE UNIDADE DE EDUCAÇÃO INFANTIL MUNICIPAL. ENDEREÇO: RUA C7, PRAÇA SE-2B, SETOR NOVO. CEP: 78.590-000, PARANAITA - MT					
Assunto:		PLANTA BAIXA E VISTAS DO FRALDÁRIO, SANITÁRIOS PCD FEM. E MASC. E LACTÁRIO.					
Cliente:		PREFEITURA MUNICIPAL DE PARANAITA CNPJ: 03.239.043-0001-12					
Áreas:		Área do Terreno 2830,77m² A Construir 997,90m² Calçada Revestida com Cer. 298,31m² Calçada de Bloco Intertravado 1055,51m² Grama 1203,21m² Muro 229,18m					
Localização Esquemática:				Responsáveis Técnico pela Elaboração e Execução dos Projetos ALEX OSCAR DE SOUSA Engenheiro Civil CREA - PR 141259/D			
Autenticações		Empresa: A O DE SOUSA EIRELI - ME CNPJ: 17.787.272/0001-86 TELEFONE: (66) 3541-4607					